

Printing Instructions

General Rules

- Use Scale 100%
- Pick The Correct Paper Size (A4, A3, A2, A1)
- For Bigger Sizes, it is recommended to visit a print shop to avoid any issues
- Check the orientation (Portrait or Landscape), all the printing methods should automatically select orientation based on the file
- After print, check the scale with a ruler using the designated 2" by 2" (5cm by 5cm) square

Printing Methods

These instructions cover only a few ways of printing, if any issues occur feel free to contact me, or visit a professional print shop. I will show you how to print using Chrome, Microsoft Edge and Adobe Acrobat Reader. Guiding images will be provided

Common Mistakes

- Do not select "Fit to Page"
- Make sure the scale is set to 100%
- A4 vs Letter size paper
- Do not try to print larger patterns on A4
- Make sure orientation is correct

Printing Instructions

Printing using Chrome

1. Open your PDF pattern in Chrome (Right click on the file, “Open With”, Select Chrome)
2. Click the printer icon in the top right of the browser

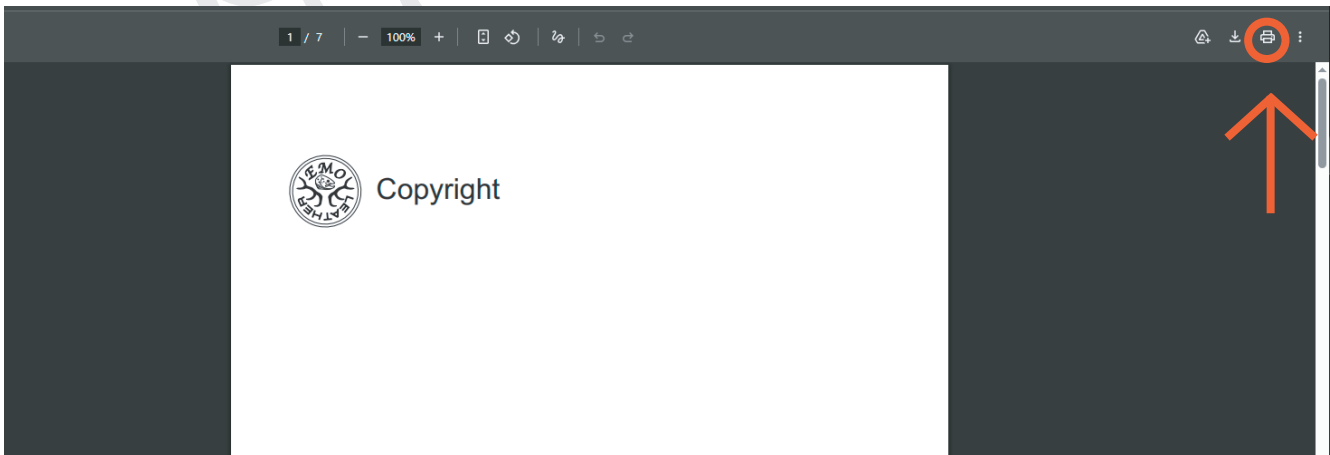

3. A print window opens, click “More Settings”

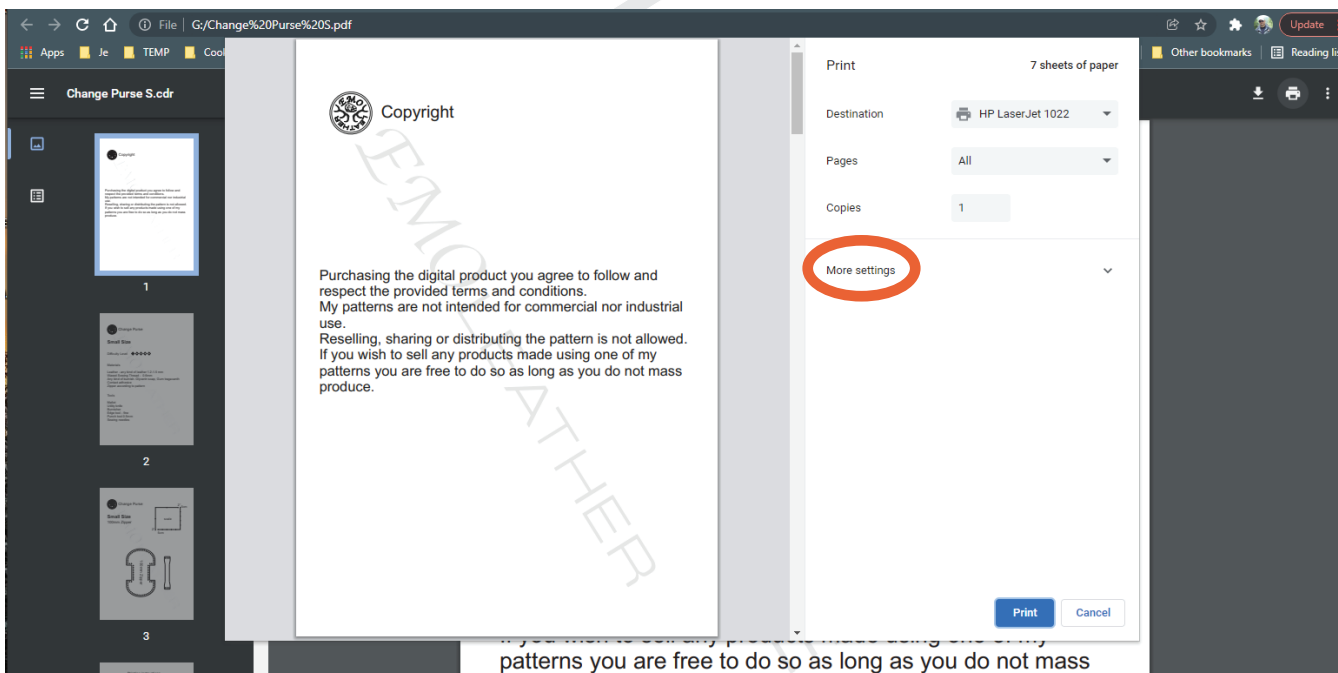

4. Set scale to default, paper size (match your file and what your printer can handle) and margins as default. Print and check scale.

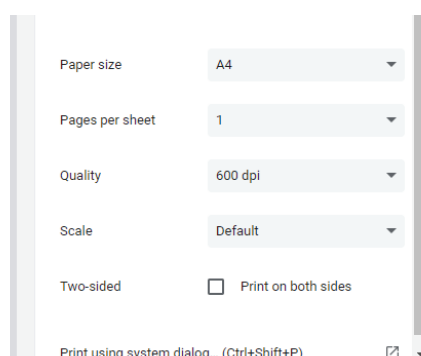

Printing Instructions

Printing using Microsoft Edge

1. Open your PDF pattern in Chrome (Right click on the file, “Open With”, Select Microsoft Edge)
2. Click the printer icon in the top right of the browser

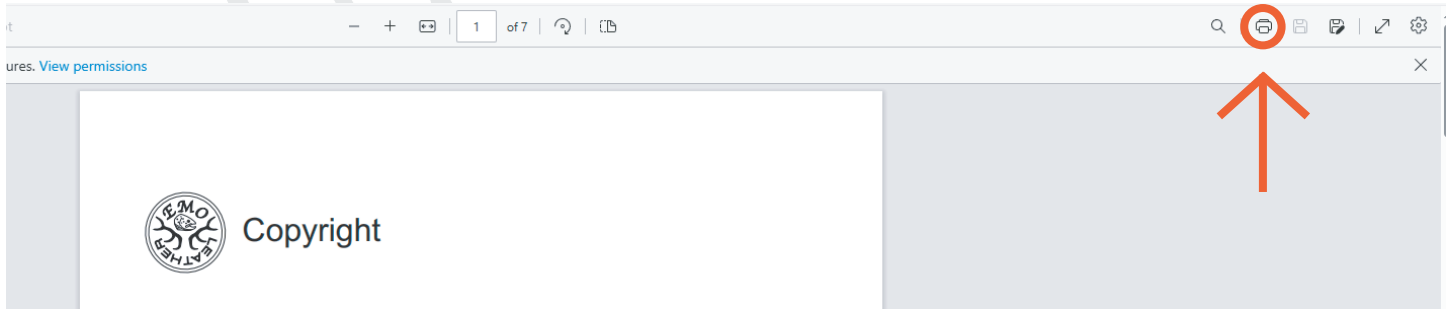

3. A print window opens, click “More Settings”

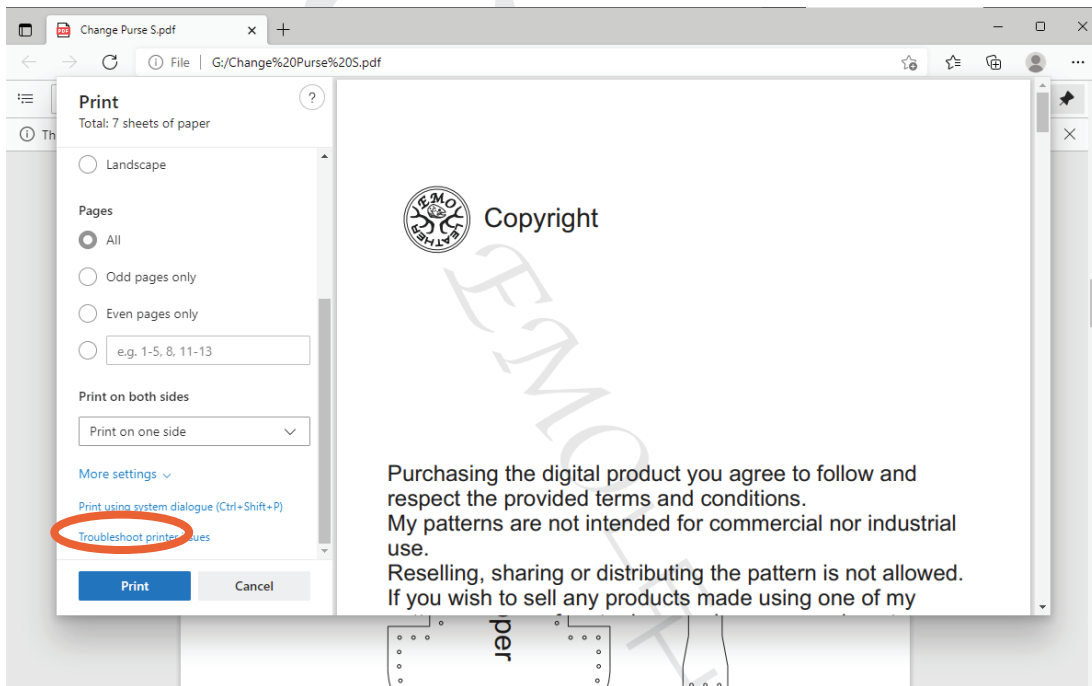

4. Set scale to 100%, paper size (match your file and what your printer can handle) and margins as default. Print and check scale.

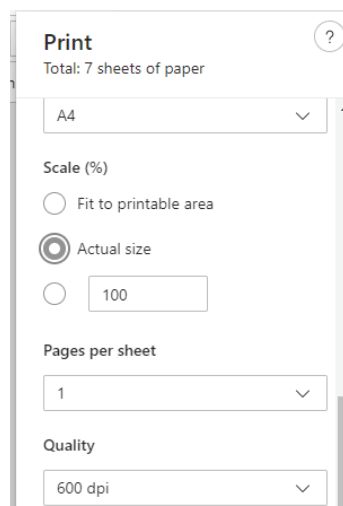

Printing Instructions

Printing using Acrobat Reader

1. Open your PDF pattern in Chrome (Right click on the file, “Open With”, Select Acrobat Reader)
2. Click the printer icon in the top left of the window

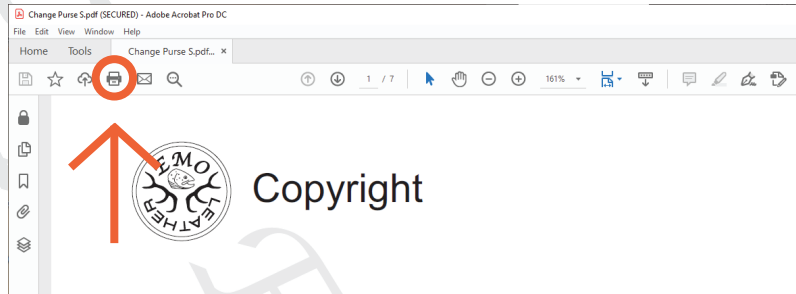

3. Set size to “Actual Size”, paper size (match your file and what your printer can handle) and orientation “Auto Portrait/ Landscape.

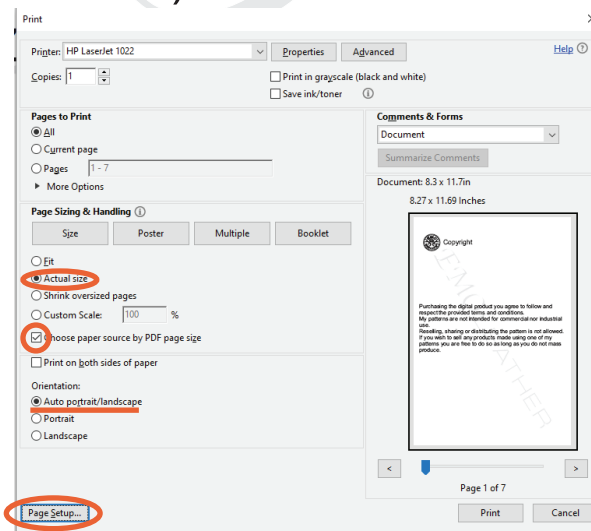

4. Go to Page Setup and select the appropriate printing paper size: A4, A3, A2, A1. Double check orientation of the file. Make sure your printer can handle larger sized paper. Print and check the scale.

